

# AMERICA'S PARK CABINS



PREMIUM CABIN SERIES





**285 Living Area**  
(TV not included. Optional items vary by model.)





## **PREMIUM CABIN SERIES**

**QUALITY, DURABILITY AND VERSATILITY YOUR INVESTMENT DEMANDS AND YOUR GUESTS EXPECT YEAR AFTER YEAR.**

The rustic elegance of Forest River Premium Rental Cabins offer guests memorable camping experiences they'll want to share with their family and friends again and again. A wide variety of floorplans are available, from studio cabins to cabins with sleeping accommodations for up to 8 guests. Forest River Premium Cabins will not only meet but will exceed your expectations.



# PREMIUM CABIN SERIES STANDARDS AND OPTIONS

## EXTERIOR

- WHITE THERMOPANE WINDOWS W/LOW-E GLASS
- 12" FRONT & REAR OVERHANGS
- 8" SIDEWALL EAVES
- GREEN METAL ROOF
- PRE-FINISHED CEMENT LAP SIDING-MAHOGANY COLOR
- 36" WHITE EXTERIOR FRONT DOOR W/INTERNAL BLIND
- EXTERIOR GFI RECEPTACLE
- 5/4 COMPOSITE DECKING ON PORCH MODELS
- PORCH SUPPORTS/ RAILINGS PAINTED TO MATCH TRIM

## INTERIOR

- HARDWOOD INTERIOR PASSAGE/POCKET DOORS
- LEVER DOOR HANDLES
- 90 INCH SIDEWALL HEIGHT
- 1" X 6" T&G PINE WALLS/CEILING
- 1" PINE TRIM THROUGHOUT
- CATHEDRAL CEILINGS (EXCEPT LOFT)
- VAULTED GABLE W/PENT WNDW (PER MODEL)
- 2" WHITE FAUX WOOD WINDOW BLINDS
- VINYL PLANK FLOORING
- BRUSHED SATIN FIXTURES THROUGHOUT
- VINYL MOP BOARD THROUGHOUT
- PREP FOR WALL MOUNT TV - MAIN AREAS
- CEILING FAN W/LIGHT KIT - MAIN AREAS
- DOUBLE SWITCHES FOR CEILING FAN
- WOOD DINETTE TABLE & 4 CHAIRS
- 2 CUSHION HIDE A BED SOFA
- QUEEN MATTRESS W/BOX SPRINGS
- 2-BUNK MATTRESSES IN BUNK ROOM (PER PLAN)
- POWDER COATED STEEL BUNK RAIL & LADDER
- SMOKE DETECTOR ON CEILING
- LP GAS-LEAK DETECTOR
- FIRE EXTINGUISHER

## BATHROOM & KITCHEN

- HIGH-DEFINITION LAMINATE COUNTERTOPS
- 3" LAMINATE BACKSPLASHES
- STAINLESS STEEL KITCHEN SINK
- BATH SINK W/OVERFLOW
- LIGHTED BATH EXHAUST FAN
- CURVED SHOWER ROD W/CURTAIN
- 1 PC. FIBERGLASS TUB/SHOWER OR SHOWER STALL
- SINGLE LEVER FAUCET - KITCHEN & BATH
- DOUBLE OVERHEAD WOOD SHELVES IN KITCHEN
- CONCEALED HINGES ON CABINET DOORS
- "DESIGNER" CABINET DOOR PULLS
- APPLIANCE PACKAGE (PER PLAN)

## UTILITIES/ INSULATION

- R-14 BATTEN INSULATION IN FLOOR
- R-11 BATTEN INSULATION IN WALLS
- R-22 BATTEN INSULATION IN ROOF
- OSB EXT. SHEATHING W/HOUSEWRAP WIND BARRIER
- RADIANT HEAT W/INDIVIDUAL THERMOSTATS
- 50 AMP ELECTRICAL SERVICE W/POWER CORD
- 20 GALLON ELETRIC WATER HEATER
- THRU-WALL AC UNIT(S) - PER PLAN
- ILLUMINATED LIGHT SWITCHES - PER LOCATION
- ROCKER STYLE LIGHT SWITCHES - THROUGHOUT
- BLACK IRON GAS PIPING
- PEX WATER LINES W/LOW POINT DRAIN
- IN-LINE WATER SHUT OFF VALVES @ TOILET & SINKS

## CONSTRUCTION FEATURES

- SOLID STEEL DUAL I-BEAM CHASSIS
- DETACHABLE HITCH
- POLY-WOVEN SIMPLEX UNDERBELLY MATERIAL
- 2" X 6" DOUBLE PERIMETER FLOOR JOISTS
- 2" X 6" FLOOR JOISTS - 16" O.C.



### **CONSTRUCTION FEATURES (CONTINUED)**

- 2" X 4" SIDEWALL STUDS - 16" O.C.
- T & G FLOOR DECKING
- RAFTERS - 16" O.C.
- INTEGRATED STEEL STRAPPING CONSTRUCTION
- RVIA/ANSI 119.5 SEAL

### **POPULAR OPTIONS**

- LP FURNACE W/HEAT DUCTS
- GLASS-TOP ELECTRIC 2 BURNER COOKTOP
- GAS 2 BURNER COOKTOP W/AUTO- IGNITE
- NO SIDE EAVES (CREDIT)
- ADDITIONAL 8,000 BTU THRU-WALL AC UNIT
- METAL UNDERBELLY
- MOEN KITCHEN AND BATH FIXTURES
- SERTA 60 X 74 MATTRESS & BOX SPRING



EVERGREEN

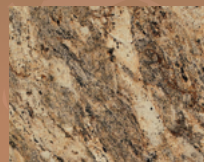

LAPIDUS  
COUNTERTOP



PLANK LINOLEUM  
FLOORING



TONGUE AND GROOVE  
PINE WALL

## DECOR OPTIONS

# PREMIUM CABIN FLOORPLANS

# NON-LOFT FLOORPLANS

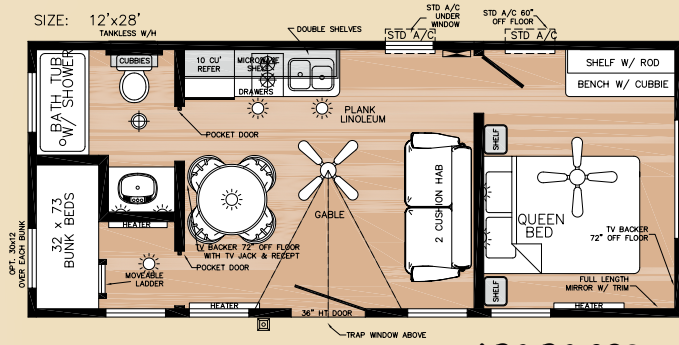

APC PC 28S

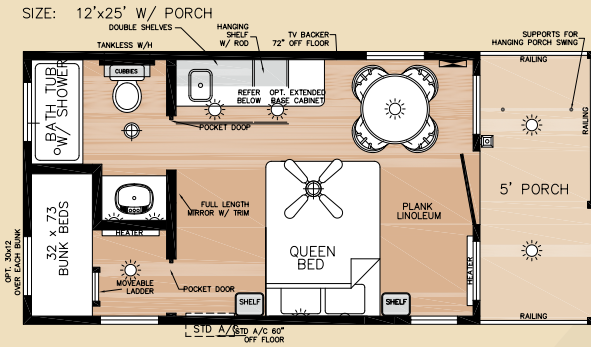

APC PC 20FP

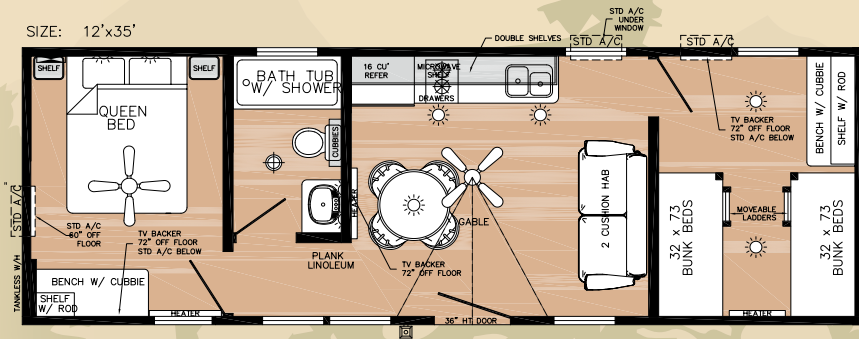

APC PC 35S

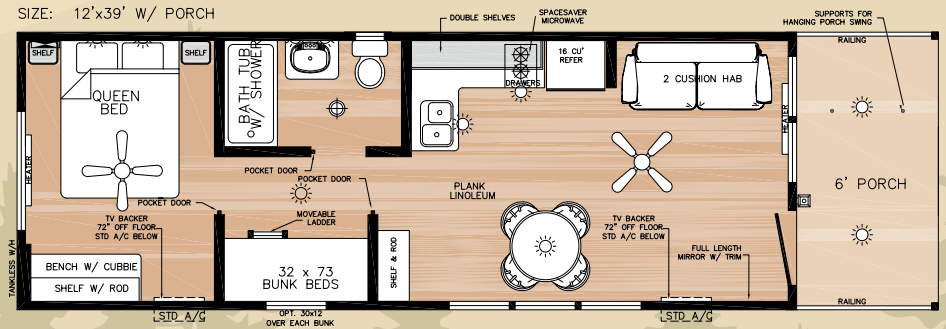

APC PC 33FP

# LOFT FLOORPLANS

SIZE: 12'x28'

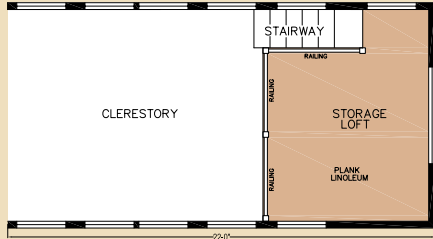

SIZE: 12'x33'

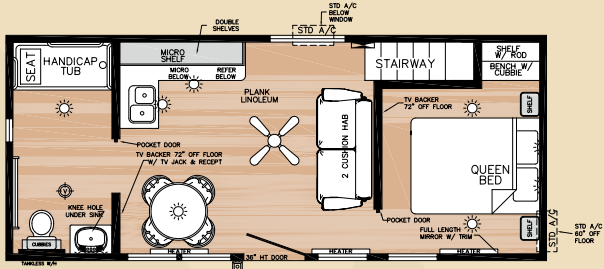
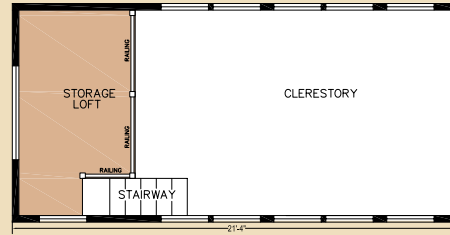

APC PC 28SHL

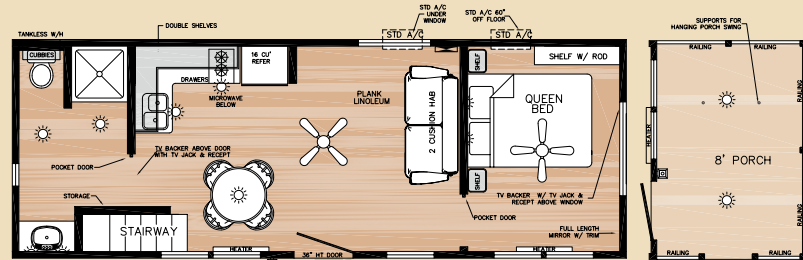

APC PC 33SHPL

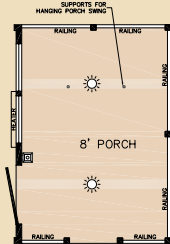

OPTIONAL 8' PORCH

SIZE: 12'x35'

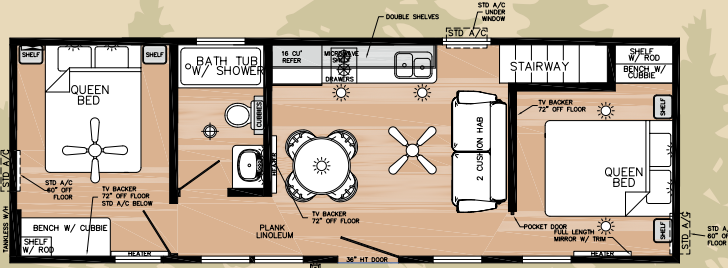
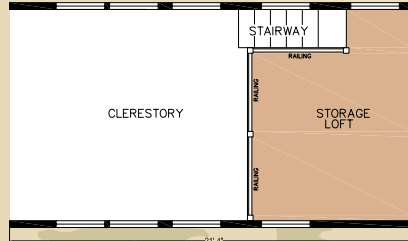

APC PC 35SL





Forest River, Inc. Park Model Division  
28936 Phillips St.  
Elkhart, IN 46514  
Phone: (574) 264-7163  
Fax: (574) 264-7364  
[www.forestriverinc.com](http://www.forestriverinc.com)  
[www.forestriveraccessories.com](http://www.forestriveraccessories.com)



**Learn More**  
Scan this barcode using  
a QR Reader on your  
smart phone to learn  
more about Forest River.



A Berkshire Hathaway company.

All information contained in this brochure is believed to be accurate at the time of publication. However, during the model year, it may be necessary to make revisions and Forest River, Inc., reserves the right to make all such changes without notice, including prices, colors, materials, equipment and specifications as well as the addition of new models and the discontinuance of models shown in this brochure. Therefore, please consult with your Forest River dealer and confirm the existence of any materials, design or specifications that are material to your purchase decision. All units are shipped F.O.B. Elkhart, IN CONSULT YOUR LOCAL DEALER FOR WARRANTY INFORMATION

© 2024- America's Park Cabins- a division of Forest River Inc.  
A Berkshire Hathaway company